

DC Series

Height adjustment & Swiveling (360°)

Ø50 Taper angle: 1°26'16"

Ø50 Non tapered, for flat bases

Ø40 Taper angle: **1°26'16"** & 1°30'26" & 1°8'46"

Short drop through base (Very **flat bases**)

Long **drop through** (High bases)



DOUBLE TUBE: Non-self-supporting gas springs are designed with a distinct structural configuration. In this setup, the tube containing the gas is separate from the component that bears the chair's weight. The gas cylinder is encased in a non-pressurized structural outer sleeve, which adds an extra layer of safety and stability.

When it comes to chair safety and security, double tube gas springs are often regarded as a more secure option. This is because the structural tube is primarily subjected to axial forces, meaning it does not endure the internal gas pressure simultaneously. As a result, the design minimizes the risk of failure, ensuring that the chair remains safe for the user. This configuration allows for better weight distribution and enhances the overall performance and durability of the chair.



Several finished & Customized colours

Several finishes: Paints, bright chromed, matt chromed...etc



International Standards

Abain's manufactured DC Series gas springs have undergone durability testing as per **EN1335-3:2000**. This standard applies to gas springs designed for office seating, accommodating users weighing up to 110 kg for up to 8 hours a day.

Additionally, the DC Series gas springs are available for intensive use, adhering to **BS5459-2:2000+A2:2008**. This standard is intended for gas springs used in office seating for individuals weighing up to 150 kg or utilized for up to 24 hours a day.

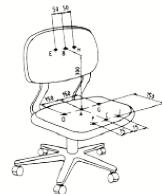

tecnalia Inspiring Business

Push Button Height

Abain produces gas springs featuring various push button heights, which are crucial for proper activation within the chair mechanism. This ensures that the button does not become pre-activated when installed, nor does it prevent the lever from successfully activating it.



Various strength options are available: 400N, 320N, 200N, and 150N.

The lower strength ratings are primarily designed for children's chairs.



End-of-Stroke Damping (Optional)

The gas spring features a rubber stop at the stroke's end. Additionally, a spring can be incorporated for end-stroke damping, providing enhanced comfort.



Grease Stopper in the Plastic Bush (Optional)

This component plays a crucial role in preventing lubrication grease from leaking. It helps eliminate grease marks around the cylinder, making it a popular choice in medical and laboratory seating.



With conductive properties, ie make the cylinder conductive or antistatic, avoiding the accumulation of static electricity. Commonly used in laboratories and specific assembly lines.



DC Series, the models...

Abain	AA	R	F1	F	GK	E	D	C	I	B	L
DC095-5013	145	41	400N	108	48	60	106	154	12	147	195
DC095-5014	145	41	400N	108	63	45	91	154	12	132	195
DC092-7504	158	60	400N	122	48	26	148	196	12	228	276
DC092-7014	158	60	400N	130	70	60	106	176	12	166	236
DC092-7015	158	60	400N	130	85	60	91	176	12	151	236
DC000-7508	183	80	400N	151	48	103	148	196	11	228	276
DC000-7001	183	80	400N	151	70	81	126	196	11	206	276
DC000-7005	183	80	400N	151	85	66	111	196	11	191	276
DC000-7003	183	80	400N	151	95	56	101	196	11	181	276
DC000-7012	183	80	400N	151	105	46	91	196	11	171	276
DC000-9004	183	80	400N	151	130	21	66	196	11	146	276
DC000-9052	183	80	400N	151	147	4	49	196	11	129	276
DC001-7000	198	95	400N	171	70	101	141	211	6	236	306
DC001-7102	198	95	400N	171	85	86	126	211	6	221	306
DC001-7104	198	95	400N	171	95	76	116	211	6	211	306
DC001-7106	198	95	400N	171	105	66	106	211	6	201	306
DC001-7107	198	95	400N	171	115	56	96	211	6	191	306
DC001-9009	198	95	400N	171	125	46	86	211	6	181	306
DC001-9010	198	95	400N	171	135	36	76	211	6	171	306
DC001-9054	198	95	400N	171	167	4	44	211	6	139	306
DC004-5009	213	110	400N	176	48	128	173	221	11	283	331
DC004-7008	213	110	400N	181	70	111	156	226	11	266	336
DC004-7110	213	110	400N	181	85	96	141	226	11	251	336
DC004-7112	213	110	400N	181	95	86	131	226	11	241	336
DC004-7114	213	110	400N	181	105	76	121	226	11	231	336
DC004-7116	213	110	400N	181	115	66	111	226	11	221	336
DC004-7117	213	110	400N	181	125	56	101	226	11	211	336
DC004-7103	213	110	400N	181	140	41	86	226	11	196	336
DC004-9007	213	110	400N	181	160	21	66	226	11	176	336
DC004-9051	213	110	400N	181	177	4	49	226	11	159	336
DC008-5010	233	120	400N	196	48	148	193	241	11	313	361
DC008-7002	233	120	400N	201	70	131	176	246	11	296	366
DC008-7004	233	120	400N	201	85	116	161	246	11	281	366
DC008-7006	233	120	400N	201	95	106	151	246	11	271	366
DC008-7118	233	120	400N	201	105	96	141	246	11	261	366
DC008-7120	233	120	400N	201	115	86	131	246	11	251	366
DC008-7124	233	120	400N	201	125	76	121	246	11	241	366
DC008-7125	233	120	400N	201	135	66	111	246	11	231	366
DC008-7127	233	120	400N	201	145	56	101	246	11	221	366
DC008-7143	233	120	400N	201	150	51	96	246	11	216	366
DC008-9014	233	120	400N	201	160	41	86	246	11	206	366
DC008-9005	233	120	400N	201	170	41	76	246	11	196	366
DC008-9001	233	120	400N	201	180	41	66	246	11	186	366
DC008-9053	233	120	400N	194	190	4	56	246	11	176	366
DC0101-5010	233	130	400N	196	48	148	193	241	11	323	371
DC0101-7002	233	130	400N	201	70	131	176	246	11	306	376
DC0101-7004	233	130	400N	201	85	116	161	246	11	291	376
DC0101-7006	233	130	400N	201	95	106	151	246	11	281	376
DC0101-7118	233	130	400N	201	105	96	141	246	11	271	376
DC0101-7120	233	130	400N	201	115	86	131	246	11	261	376
DC0101-7124	233	130	400N	201	125	76	121	246	11	251	376
DC0101-7125	233	130	400N	201	135	66	111	246	11	241	376
DC0101-7127	233	130	400N	201	145	56	101	246	11	231	376
DC0101-7143	233	130	400N	201	150	51	96	246	11	226	376
DC0101-9014	233	130	400N	201	160	41	86	246	11	216	376
DC0101-9005	233	130	400N	201	170	41	76	246	11	206	376
DC0101-9001	233	130	400N	201	180	41	66	246	11	196	376
DC0101-9053	233	130	400N	194	190	4	56	246	11	186	376
DC015-7122	243	140	320N	211	70	141	186	256	11	326	396
DC015-7126	243	140	320N	211	85	126	171	256	11	311	396
DC015-7123	243	140	320N	211	95	116	161	256	11	301	396
DC015-7131	243	140	320N	211	105	106	151	256	11	291	396
DC015-7132	243	140	320N	211	115	96	141	256	11	281	396
DC015-7133	243	140	320N	211	125	86	131	256	11	271	396
DC015-7136	243	140	320N	211	135	86	121	256	11	261	396
DC015-7141	243	140	320N	211	150	61	106	256	11	246	396
DC015-7144	243	140	320N	211	160	51	96	256	11	236	396
DC015-9015	243	140	320N	211	180	31	76	256	11	216	396
DC015-9015	243	140	320N	211	207	4	49	256	11	189	396
DC016-5030	254	150	320N	226	48	178	214	262	12	364	412
DC016-7022	254	150	320N	221	70	151	197	267	12	347	417
DC016-7020	254	150	320N	221	85	136	182	267	12	332	417
DC016-7026	254	150	320N	221	95	126	172	267	12	322	417
DC016-7036	254	150	320N	221	105	116	162	267	12	312	417
DC016-7040	254	150	320N	221	115	106	152	267	12	302	417
DC016-7042	254	150	320N	221	125	96	142	267	12	292	417
DC016-7043	254	150	320N	221	130	91	137	267	12	287	417
DC016-7134	254	150	320N	221	170	51	97	267	12	247	417
DC016-9055	254	150	320N	221	190	31	77	267	12	227	417
DC017-5030	264	140	320N	226	48	178	224	272	12	364	412
DC017-7032	264	140	320N	231	70	161	207	277	12	347	417
DC017-7034	264	140	320N	231	85	146	192	277	12	332	417
DC017-7028	264	140	320N	231	95	136	182	277	12	322	417
DC017-7038	264	140	320N	231	105	126	172	277	12	312	417
DC017-7050	264	140	320N	231	115	116	162	277	12	302	417
DC017-7052	264	140	320N	231	125	106	152	277	12	292	417
DC017-7039	264	140	320N	231	130	101	147	277	12	287	417
DC017-7109	264	140	320N	231	145	86	132	277	12	272	417
DC017-7041	264	140	320N	231	150	81	127	277	12	267	417
DC017-7113	264	140	320N	231	155	76	122	277	12	262	417
DC017-7048	264	140	320N	231	170	61	107	277	12	247	417
DC017-7048	264	140	320N	231	180	51	97	277	12	237	417
DC025-5030	264	155	320N	226	48	178	224	272	12	379	427
DC025-7032	264	155	320N	231	70	161	207	277	12	362	432
DC025-7034	264	155	320N	231	85	146	192	277	12	347	432
DC025-7028	264	155	320N	231	95	136	182	277	12	337	432
DC025-7038	264	155	320N	231	105	126	172	277	12	327	432
DC025-7050	264	155	320N	231	115	116	162	277	12	317	432
DC025-7052	264	155	320N	231	125	106	152	277	12	307	432
DC025-7039	264	155	320N	231	130	101	147	277	12	303	433
DC025-7109	264	155	320N	231	145	86	132	277	12	289	434
DC025-7041	264	155	320N	231	150	81	127	277	12	285	435
DC025-7113	264	155	320N	231	155	76	122	277	12	281	436
DC025-7048	264	155	320N	231	170	61	107	277	12	267	437
DC025-7048	264	155	320N	231	180	51	97	277	12	258	438
DC050-7072	287	175	320N	246	70	176	230	300	20	405	475
DC050-7070	287	175	320N	246	85	161	215	300	20	390	475
DC050-7068	287	175	320N	246	95	151	205	300	20	380	475
DC050-7158	287	175	320N	246	105	141	195	300	20	370	475
DC050-7160	287	175	320N	246	115	131	185	300	20	360	475
DC050-7162	287	175	320N	246	125	121	175	300	20	350	475
DC050-7092	287	175	320N	246	135	111	165	300	20	340	475
DC050-7164	287	175	320N	246	155	91	145	300	20	320	475
DC050-7100	287	175	320N	246	170	76	130	300	20	305	475
DC057-7058	303	155	320N	256	70	186	246	316	31	400	470
DC057-7176	303	155	320N	256	85	171	2				

DC Series, the models... Also available in...

Not all the possibilities can be shown
in the catalogue, so... do not hesitate to ask!



... non tapered tubes for flat bases: **Ø50 & Ø45**

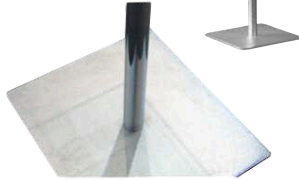

Standpipe WITHOUT TAPER – To assemble directly on flat bases

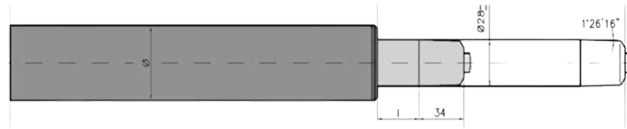
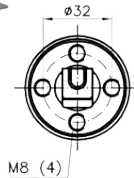

Available in Ø45 and Ø50

... Several outer tube/column diameters and angles **Ø50 & Ø45 & Ø40**

Serie	Ø	Taper angle	Taper length GK measure
7000 Series	Ø50	1°26'16''	From 70mm up to 170mm
5000 Series		1°26'16''	From 48mm up to 63mm
9000 Series		1°26'16''	Up to 190mm
4000 Series	Ø40	1°8'46''	63mm
4200 Series		1°30'26''	From 35mm up to 180mm
3300 Series		1°26'16''	From 45mm up to 180mm
4500 Series	Ø45	2°35''	From 66mm up to 100mm

... Short drop through, special for low bases with small space to the floor

